



JEY GREY RESIDENCE Townhouses



DM PROJECTS

JEY GREY RESIDENCE FEATURES

- PANORAMIC WINDOWS
- LOFT-STYLE INTERIOR
- RELAXATION CORNER
- INFINITE POOL
- LUSH GARDEN

FOR MORE OPTIONS, GET IN TOUCH WITH US TODAY!





LIVING ROOM & RELAXATION CORNER

- **INDUSTRIAL CHARM WITH SOPHISTICATED DECOR**
- **MOOD LIGHTING WITH THOUGHTFULLY DESIGNED LIGHTING SCENARIOS**
- **THE FUNCTIONALITY OF OPEN-SPACE LAYOUTS WITH ACCENT FURNITURE**
- **FULLY EQUIPPED ELEGANT KITCHEN WITH A BAR COUNTER**
- **EVERYTHING YOU NEED FOR YOUR STYLISH LIFE**

PRIVATE COMFORT

- BOLD ELEGANCE
- ULTIMATE COMFORT
- URBAN ESCAPE
- MODERN MASCULINITY
- SENSE OF INTIMACY





FUNKY FUTURISTIC NIGHT VIEW

- **EDGY AND VIBRANT LIGHT DESIGN**
- **URBAN SERENITY**
- **CUTTING-EDGE COMFORT**
- **COSMIC AMBIENCE**
- **TECH-INFUSED CALM**

JEY GREY RESIDENCE

- 100M² LAND AREA
- 73M² LIVING AREA
- 0% – INSTALLMENT PLANS
- 30 YEARS LEASEHOLD

AVAILABLE NOW FROM 135,000 USD

CONTACT US TODAY TO UNLOCK YOUR SPECIAL OFFER!





BOLD, BEAUTIFUL, AND BRILLIANTLY CRAFTED

SPACIOUS TWO-STORY VILLAS: Thoughtfully designed with two luxurious bedrooms.

LIVING ROOM WITH A VIEW: Floor-to-ceiling panoramic windows overlooking your private garden and pool.

EXPANSIVE SHARED POOL: A stunning 8x20 meter oasis for relaxation and leisure.

SEAMLESS INDOOR-OUTDOOR LIVING: Front entrance opens directly to the poolside, blending comfort and style.

LOUNGE IN LUXURY: Cozy sofa areas by the pool, perfect for unwinding in ultimate serenity.

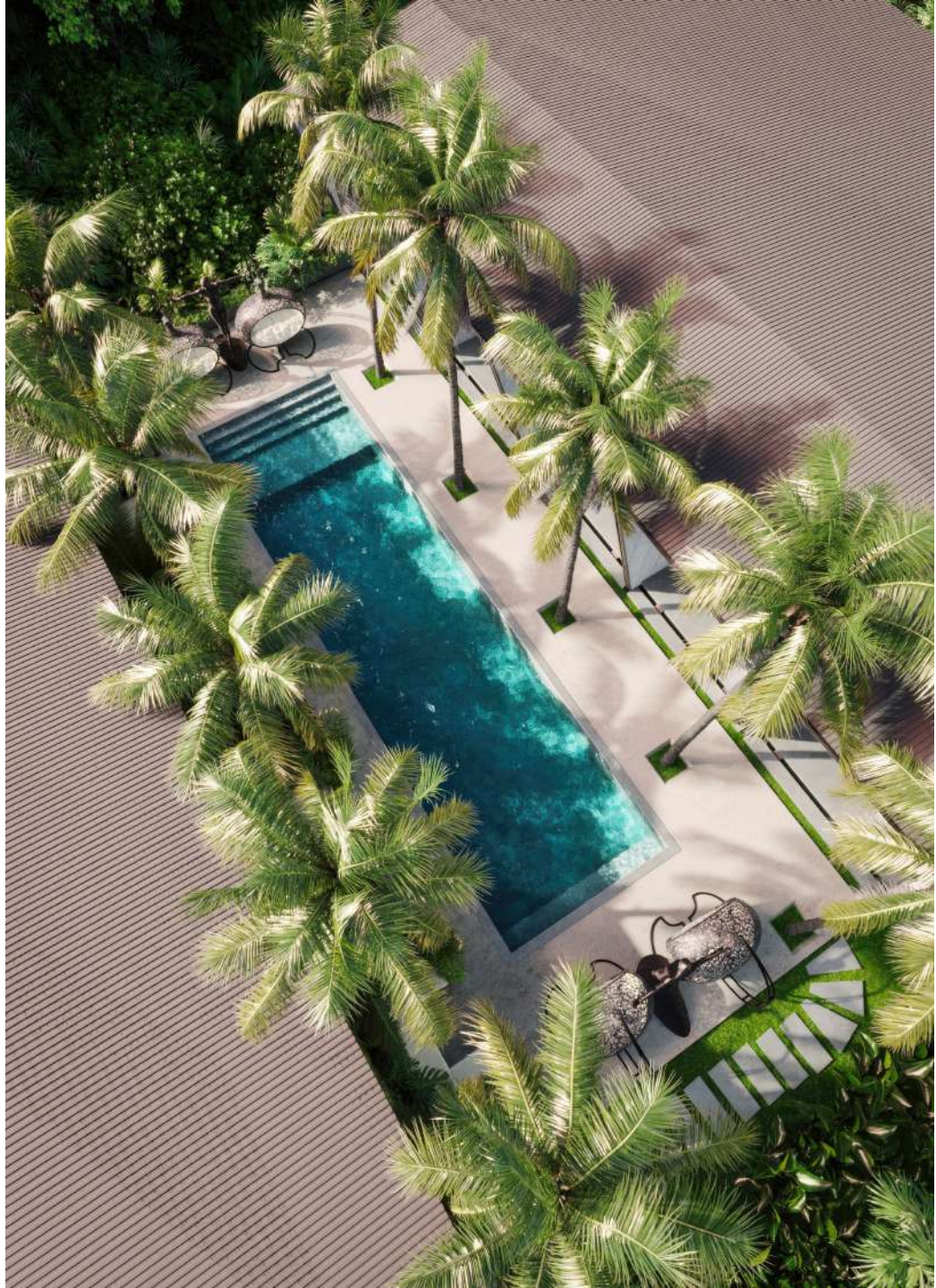

LOCATION



→ **3 MINUTES**

Walk to GWK Cultural Park

→ **10 MINUTES**

Drive to BSI International Clinics at GWK
Jimbaran

→ **30 MINUTES**

Gusti Ngurah Rai International Airport

→ **VIEW**

Of Garuda Wisnu Kencana Statue

→ **CHECK IT ON MAP**

[Click here](#)



CONTACT US

WhatsApp:

+15557051766

E-mail:

dmbalisales@gmail.com